

CAL. 1L/MXX
 MOVEMENT SPECIFICATIONS
CAL. 1L/MXX SERIES ANALOG QUARTZ MOV'T
 BY CITIZEN WATCH CO., LTD. JAPAN
NEW FLAT RANGE
 MANUFACTURED IN JAPAN

1. BASIC SPECIFICATION

(1) CAL. NO.

*TO CONFIRM WITH MOV'T DRAWING ATTACHED

CALIBRE	1L22	1L32	1L12	1L02	1M12	1M02
Ligne	6 X 8		6 X 8		10 1/2	
Overall length	15.3 × 18.2		15.3 × 18.2		23.7 × 22.6	
Case fitting length	15.3 × 17.8		16.1 × 17.8		23.3 × 22.6	
Total height	2.15mm	2.28mm	2.71mm	2.94mm	2.71mm	2.94mm
Hands	2	3	3			
Date	X		○	○	○	○
Day of Week	X		X	○	X	○
Battery life	5 Year	3 Year	3 Year			
Battery	SR616SW	SR621SW	SR621SW			

(2) Time standard

Type of quartz : Tuning fork type quartz crystal

Frequency : 32,768Hz

Accuracy : **+/-20 s/month** worn under normal circumstances

(3) Battery installed

Type of battery : See above: JAPAN-MADE

(4) Others

Driving systems : Two-pole stepping motor

Number of Jewel : No(0) jewel

(5) Additional Mechanisms & Features:

Quick Day/Date Change by turning crown(*1L12/02/1M12/02)

Bilingual Day of Week(*1L02/1M02)

Powercell Saving Reset Mechanism(PSRM)

Second hand stopping at optional position

Over-loading Compensation Device(OLCD)

Digital Frequency Control(DFC) for time adjustment

(6) Balanceable weight of hand

Minute hand Max. 0.4 μ N·m

Second hand Max. 0.07 μ N·m

2. SEPARATED PARTS

CAL. 1L/MXX

	1L22	1L32	1L12	1L02	1M12	1M02
Hour Wheel	075-446	075-446	075-455	075-454	075-455	075-454
Dial Washer	078-040	078-040				
Setting Stem	065-477	065-477	065-505	065-505	065-505	065-505

3. Others

* Measurement of time rate

The unit(gate) time of measurement must be set at "10s " or integer fold value of 10s owing to the DFC system, and the measurement must be performed in the form of complete watch.

* Marking on movement

NO(0) JEWEL
(CAL. NO.)
MIYOTA CO., JAPAN

* Typical clearance

Mov't - Caseback	minimum 150 μm or more
Top of hands - Glass	300 - 400 μm *

* depending and subject to the glass and case structure, and hand length

* Interchangeability of appearance components:

Dial Foot position & the diameter	same as Cal. 20/21/6L/6M series*
Day/Date window position	same as Cal. 20/21/6L/6M series*
Hands	same as Cal. 2035/20/21/6L/6M series

*respectively plain to plain, date to date and d/d to dd

*How to set time and day/date:

Day/Date	-----	Pull out crown to the first click position, then: turn crown clockwise for Weekday turn crown counter-clockwise for Date
Time	-----	Pull out crown to the second click position and turn crown until the time is set correctly**

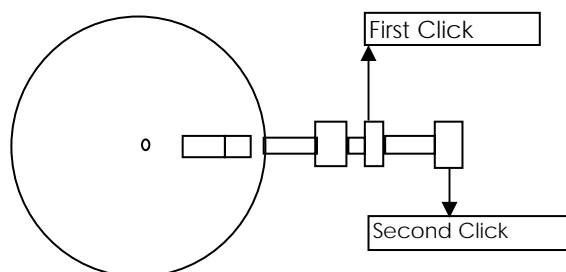

**Time Setting of CAL.1L22/32
: at the first click position

This specifications might be changed without prior notice.

This drawing is provisional and subject to our reconfirmation and/or revision without notice.

xxx T1PW 1M02 (01) xxx (2100 1121 C-01) 00-06-26

DH3~DH4=22287 (±20)

Coordinates

Mark	X	Y	R
GM	0	0	—
DH3	-8759	8600	—
DH4	8251	-7500	—
b1	8032	7877	500
b2	8624	7608	150
b3	10099	6501	150
b4	10149	4853	500
b5	7809	-8098	500
b6	7535	-8688	150
b7	5416	-10145	150
b8	4768	-10190	500
b9	-8032	-7877	500
b10	-8624	-7608	150
b11	-10099	-6501	150
b12	-10149	-4853	500
b13	-7809	8098	500
b14	-7535	8688	150
b15	-5416	10145	150
b16	-4767	10190	500

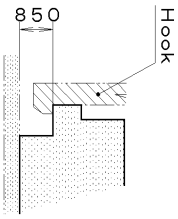

Section b1~b16

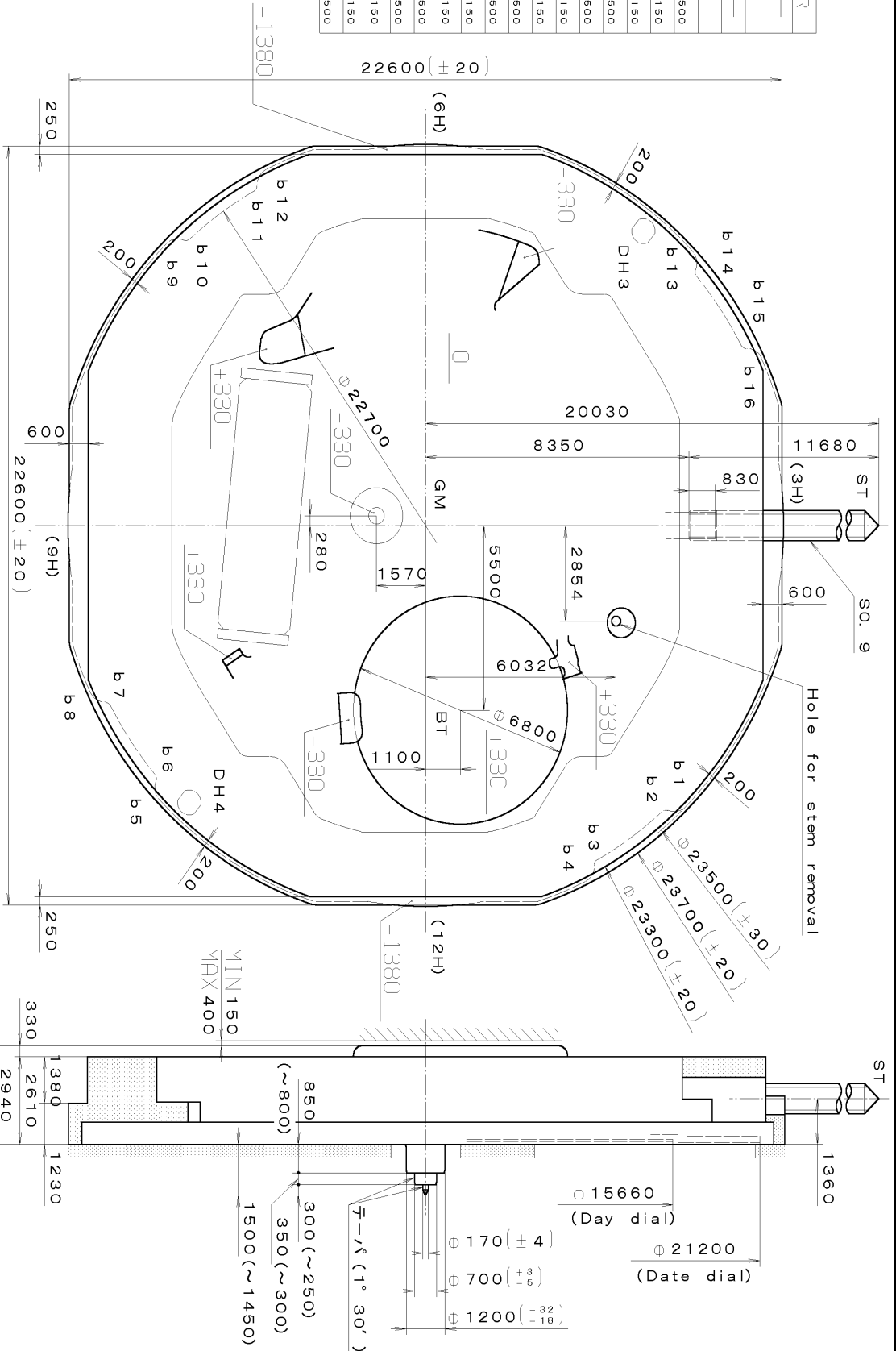

Material	Quantity	Unit	Scale	Date	Checked	Approved	Name
Heat Treatment	1/1000	mm	8:1				T. Hiruta
Hardness							
Plating							
General Tolerances							Name: Frame for Case
Dimensions							
Angles							Drawing No.: 1M02C000
MIN 150 MAX 400							

Cal. No.: 1M02

Parts:

Drawing No.: 1M02C000

Frame for Case

This drawing is provisional and subject to our reconfirmation and/or revision without notice.

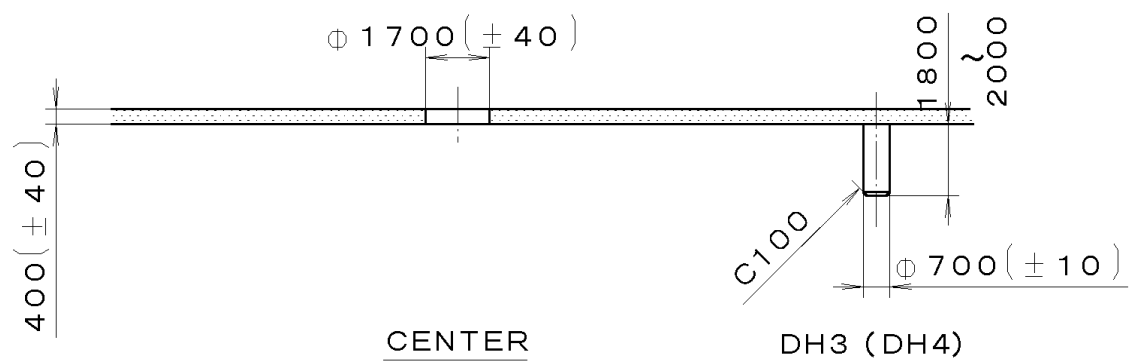
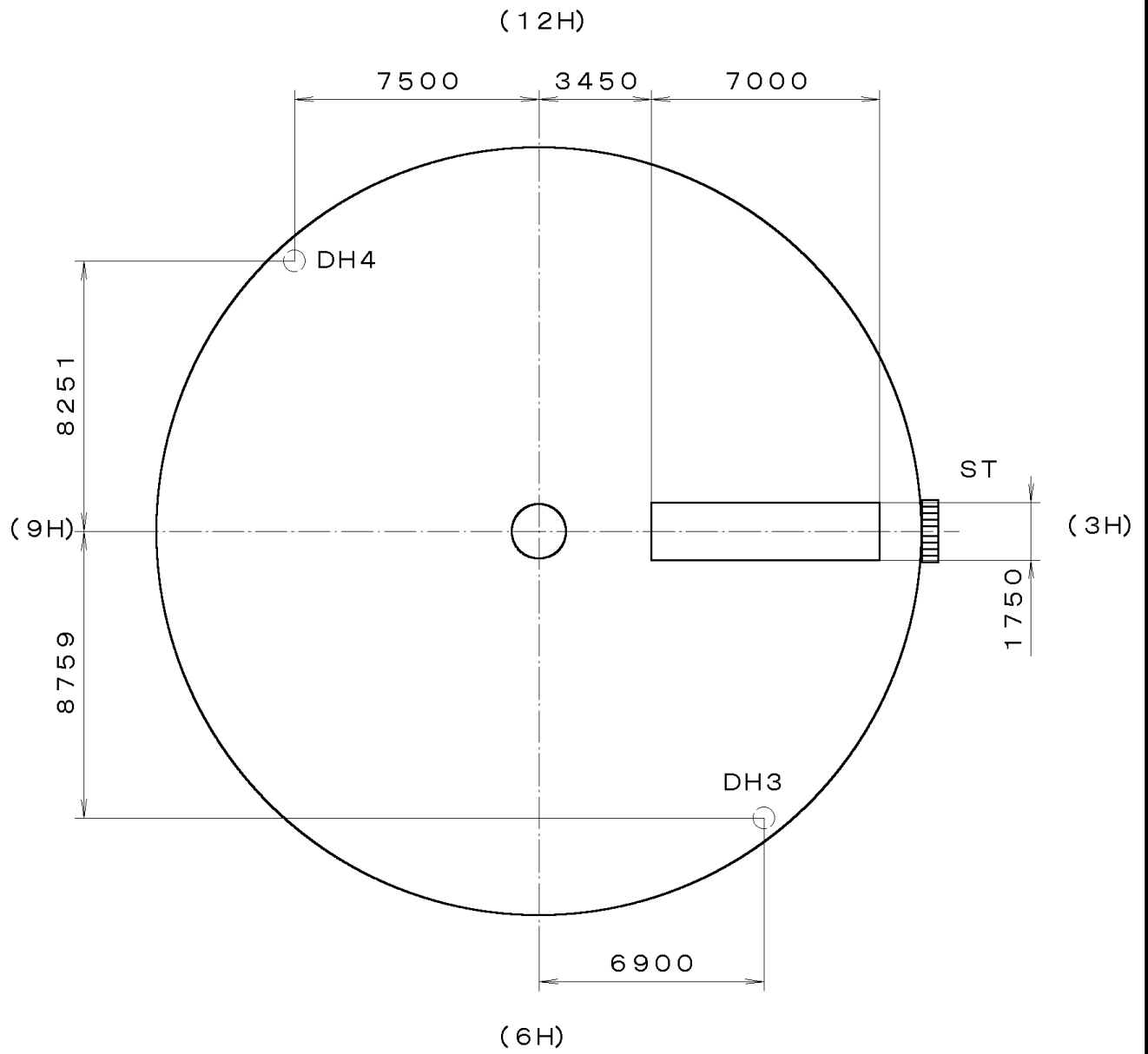

(2100 1121) 00-06-28
 1M02-10A (01) ***
 T I P W

7			Quantity		Cal. No. :
6			Unit	1/1000 mm	1M02-10A
5			Scale	5:1	Parts:
4			Date		
3			Drawn		Name:
2			Checked	T. Hiruta	
1			Approved		Indications for Dial
Material			Drawing No. : 1M02D000		
Heat Treatment			General Tolerances		
Hardness			Dimensions		
Plating			Angles		

This drawing is provisional and subject to our reconfirmation and/or revision without notice.

*** T I P W (01) *** (2100 1121) 00-06-29

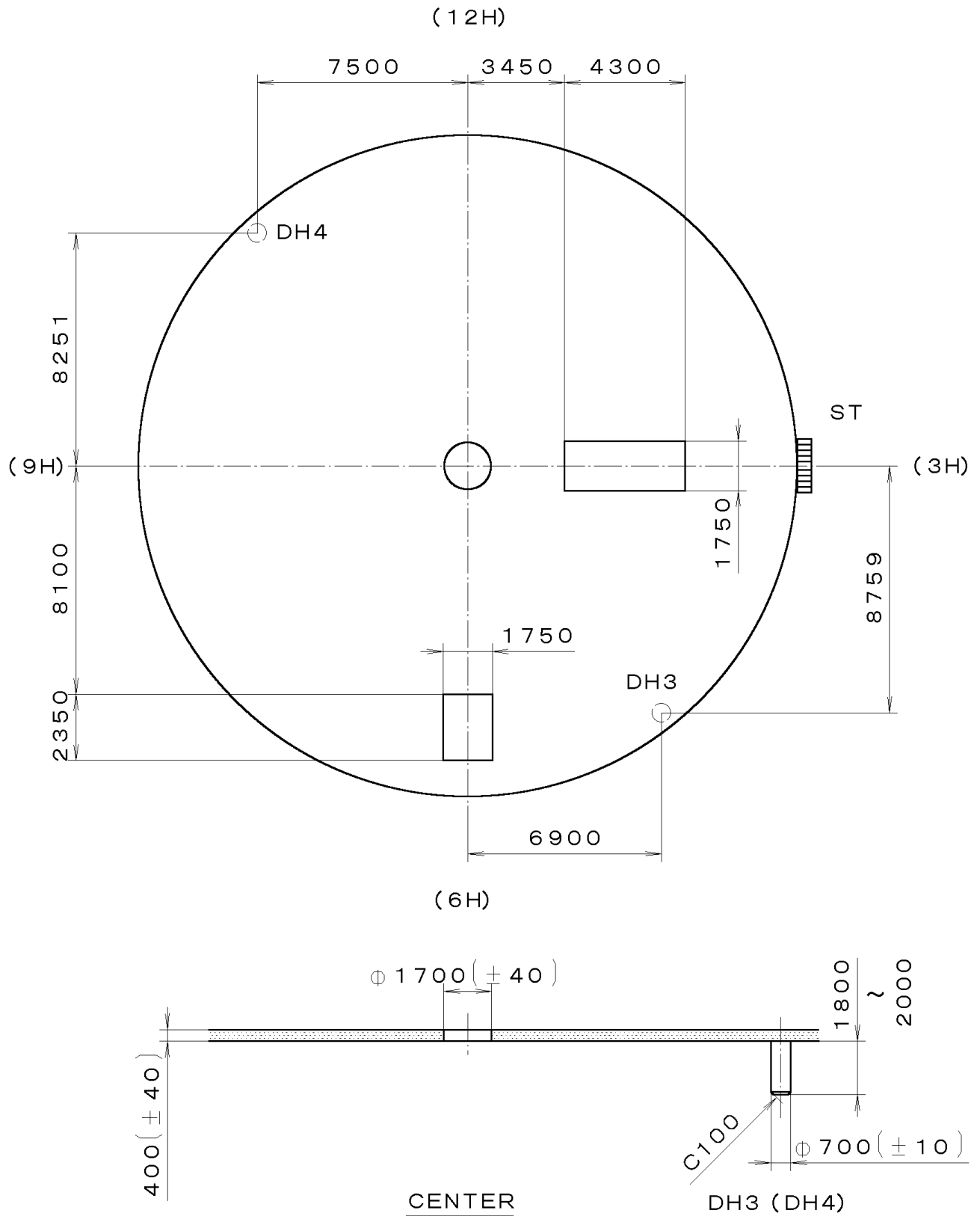

7			Quantity		Cal. No. :	1M02-1AZ
6			Unit	1/1000 mm	Parts:	
5			Scale	5:1	Name:	Indications for Dial
4			Date		Drawing No. : 1M02D030	
3			Drawn			
2			Checked	T. Hiruta		
1			Approved			
Material						
Heat Treatment			General Tolerances			
Hardness			Dimensions			
Plating			Angles			

This drawing is provisional and subject to our reconfirmation and/or revision without notice.

*** T I P W (01) *** (2100 1121) 00-06-28

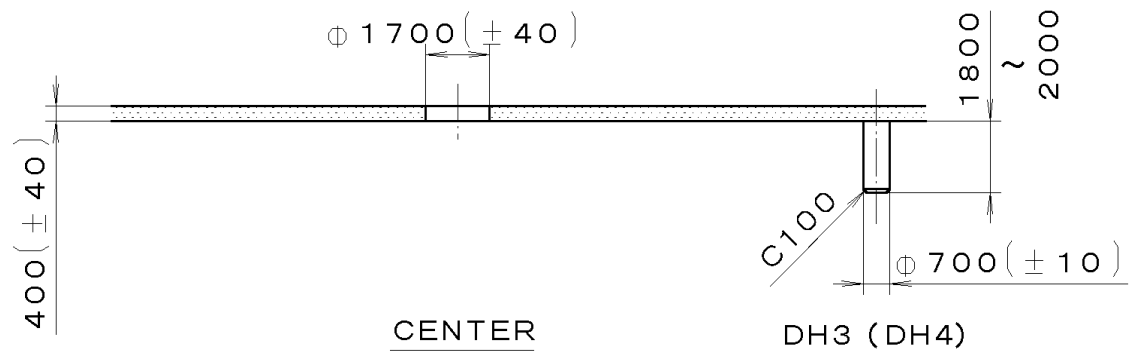
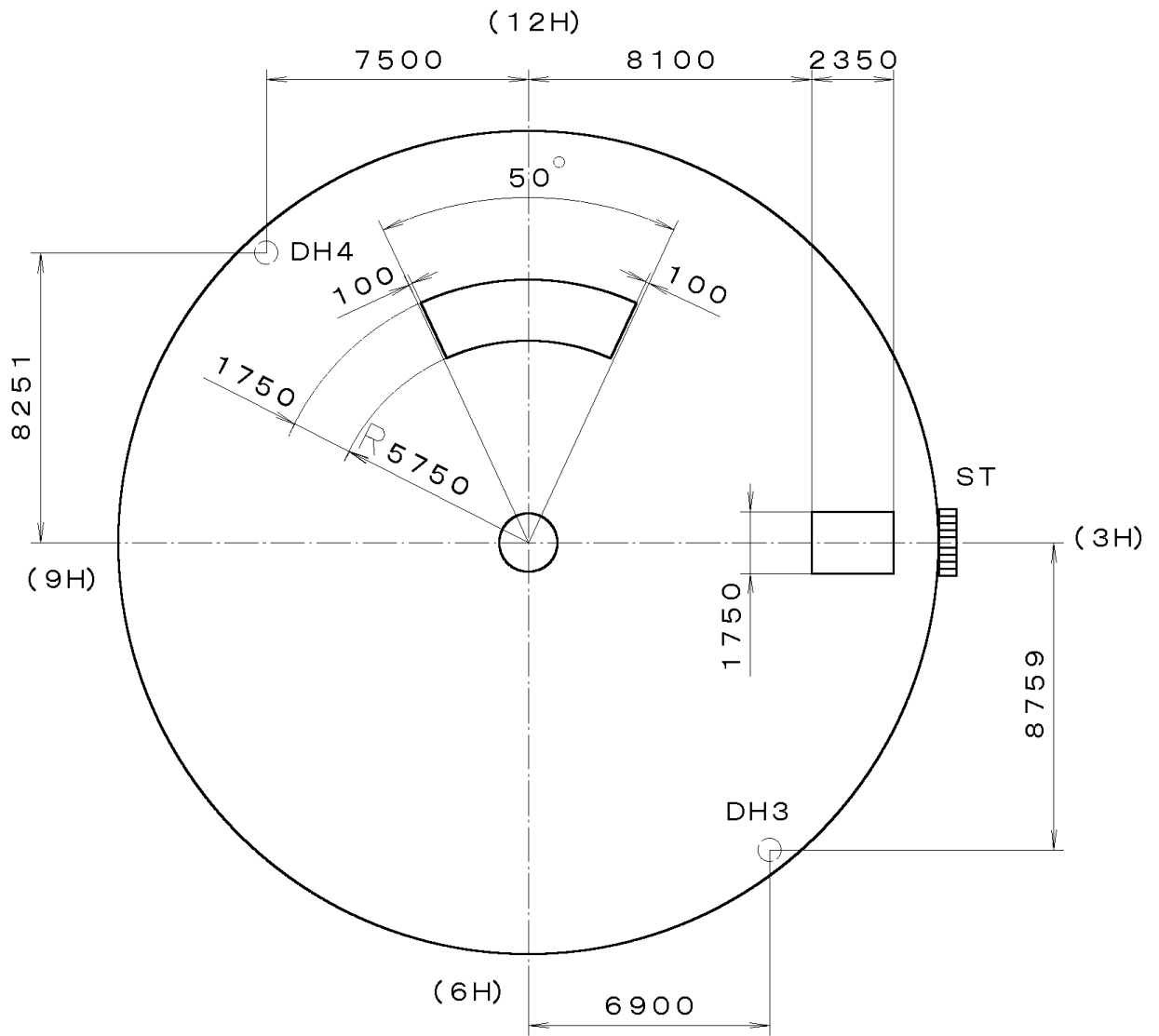

7			Quantity		Cal. No. : 1M02-1XS
6			Unit	1/1000 mm	
5			Scale	5:1	Parts:
4			Date		
3			Drawn		
2			Checked	T. Hiruta	Name:
1			Approved		Indications for Dial
Material					Drawing No. : 1M02D080
Heat Treatment			General Tolerances		
Hardness			Dimensions		
Plating			Angles		

This drawing is provisional and subject to our reconfirmation and/or revision without notice.

00-06-29) (2100 1121) (01) *** 1M02-1XY *** TIPW

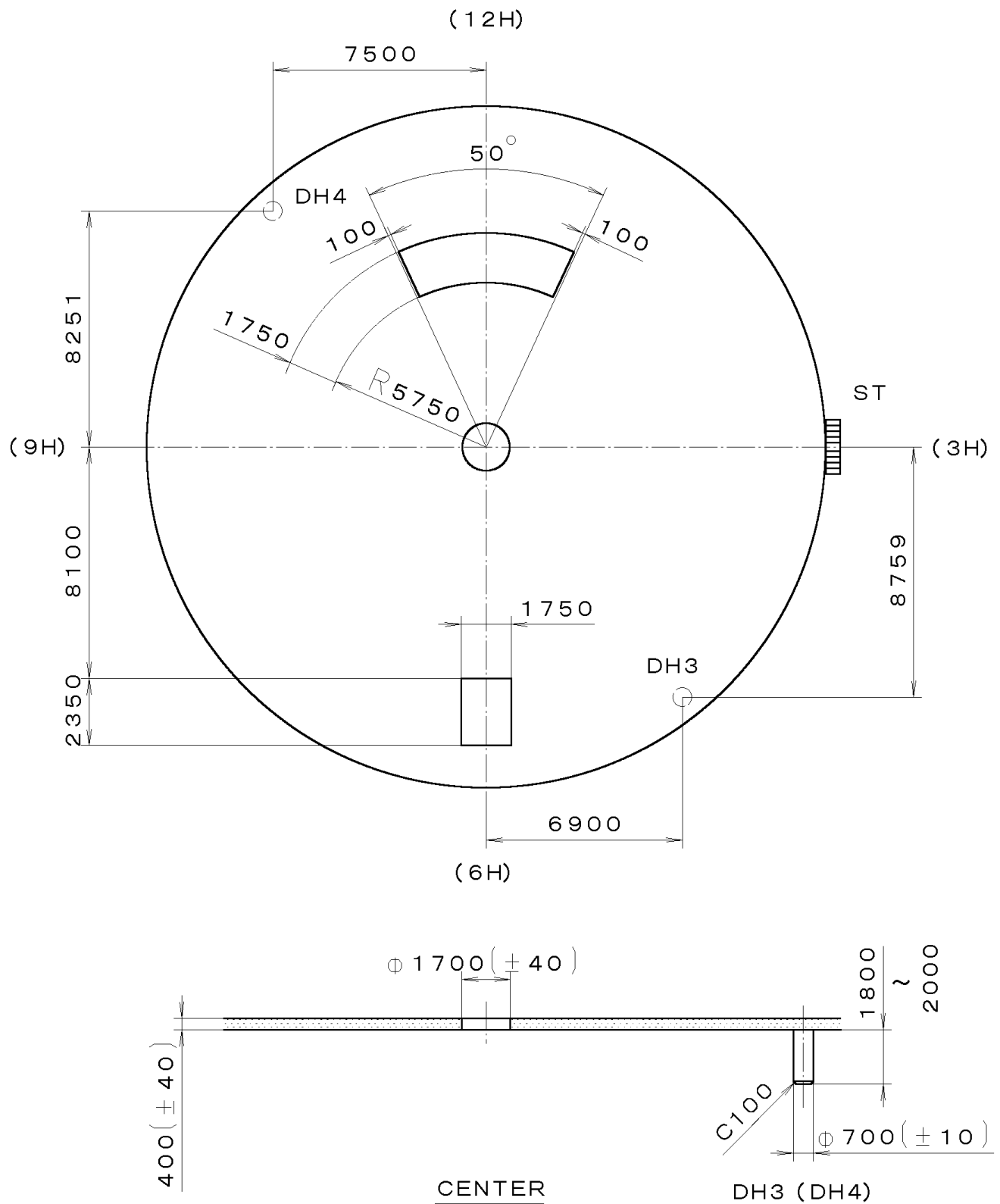

7		Quantity		Cal. No. :	1M02-1XY
6		Unit	1/1000 mm	Parts:	
5		Scale	5:1	Name:	Indications for Dial Drawing No. : 1M02D090
4		Date			
3		Drawn			
2		Checked	T. Hiruta		
1		Approved			
Material					
Heat Treatment		General Tolerances			
Hardness		Dimensions			
Plating		Angles			

This drawing is provisional and subject to our reconfirmation and/or revision without notice.

*** TIPW (01) *** (2100 1121 A-01 A-01) 00-06-22

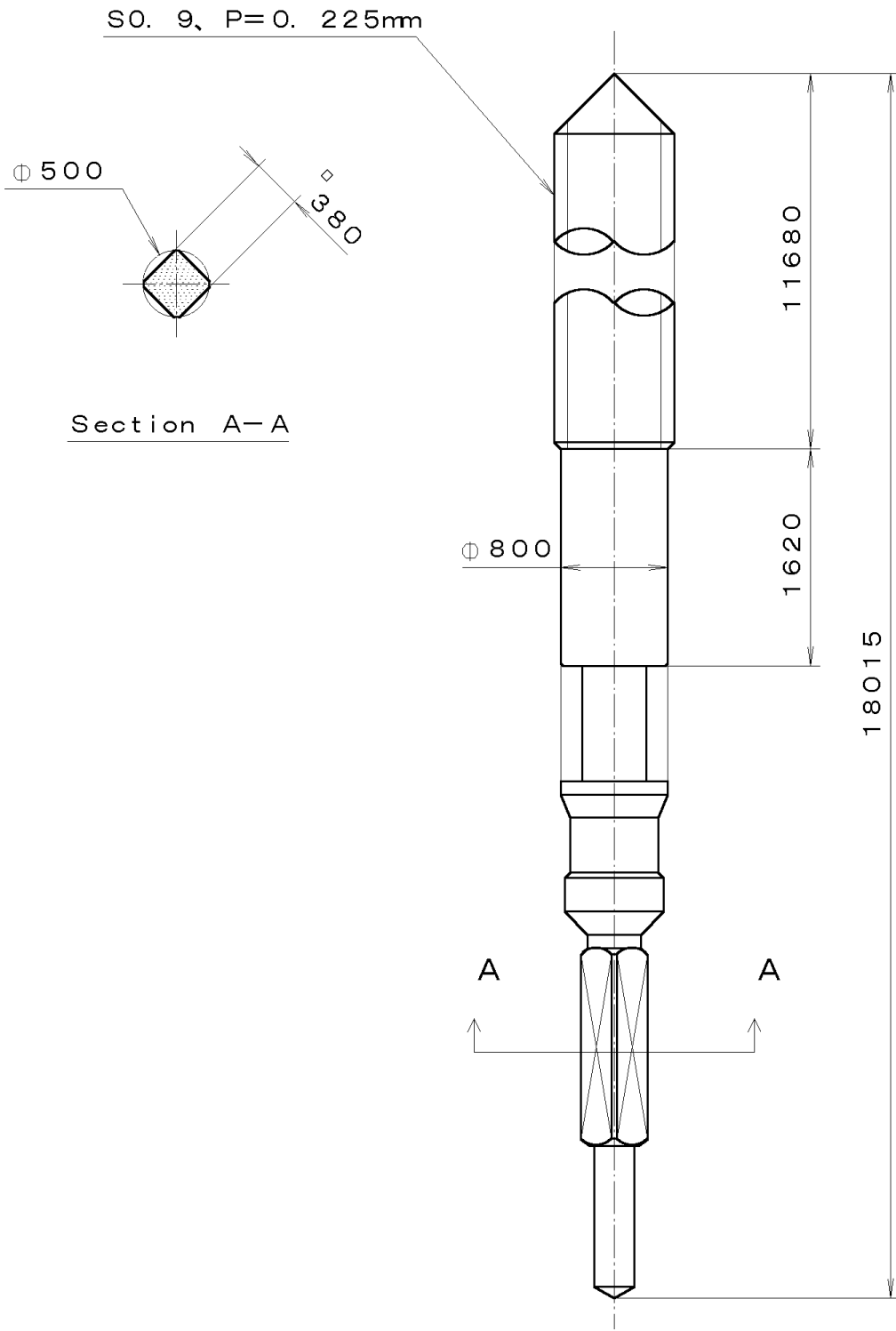

7			Quantity		Ca l. No. :
6			Unit	1/1000 mm	
5			Scale	20:1	Parts:
4			Date		065-505
3			Drawn		
2			Checked	T. Hiruta	Name:
1			Approved		SETTING STEM
Material					Drawing No. : 5050S000
Heat Treatment			General Tolerances		
Hardness			Dimensions		
Plating			Angles		