

MIYOTA

Cal. 8218 / 8219

AUTOMATIC & MANUAL WINDING MOVEMENT WITH DATE



Basic specification

Calibre	8218	8219
Ligne	11-1/2	
Overall diameter	Φ26.0mm	
Case fitting diameter	Φ25.6mm	
Total height	5.67mm	
Small second	○	○
24 Hour Hand	N/A	○
Date	○	○
Vibration frequency	21600 vibrations per hour	
Jewels	21 Jewels	

Function

Automatic & manual winding
Display by means of hands: hour, minute, small second, 24H(8219).
Date calendar
Shock-absorber for balance staff

Technical characteristics

Hands fitting force

Second hand	Max. 30N
Minute hand	Max. 50N
Hour hand	Max. 50N

Lift angle 49°

Casing Non-corresponding to "Divers' watches" defined by ISO6425

Time performance

Accuracy	-20~+40 seconds/day
Posture difference	Under 50 seconds/ day
Running time	More than 40 hours

※Accuracy of the mechanical watch is different from the daily rate of the quartz watch and the accuracy will change maximum of several ten seconds during rewinding the spring, then the accuracy of the half winding condition will be different from that of full winding condition.

<Time performance measurement condition>

Accuracy

Measure within lapse of 10 ~ 60 minutes from full winding.

Posture difference

Measure accuracy in 4 different postures shown on the right picture within lapse of 10 ~ 60 minutes from full winding.

※Direction of 4 postures ①Date Dial side Up ②6 o'clock side up ③9 o'clock side up ④3 o'clock side up

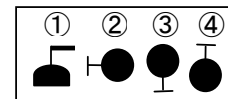

Running time

Measure the running time from full winding.

※The mainspring becomes fully wound by rotating the ratchet wheel 7.5 times (turning the crown 40 times).

Automatic winding structure

Winding direction : Counter-clockwise (seeing from case back side)



Operating method

For 8218 / 8219

(1) Winding the Mainspring

Automatic winding watch can also be hand wound by turning the crown in "A" position.
Wind 15 ~ 20 times clockwise. It will start to move naturally after shaking slightly.

(2) Setting the Time

1. Pull the crown to "C" position.
2. Turn the crown to set the hour and minute hands.

(3) Setting the Date

1. Pull the crown to "B" position.
2. Turn the crown counter-clockwise to set the date.

*If the date is set between the hours of around 9:00 PM and 1:00 AM, the date may not change on the following day.

3. After the date has been set, push the crown back to the normal position.

For 8219

When the time is set, 24hour hand at 9 o'clock moves linked with center hour hand.

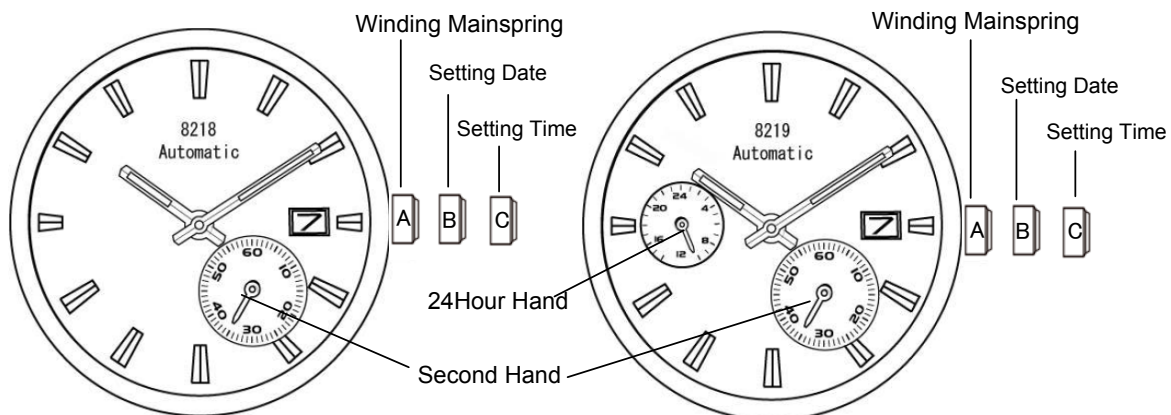

Separated parts

Winding Stem	065-212	×1
Movement Holder	500-710	×1
Screw	929-610	×2

These specifications might be changed without prior notice.

CITIZEN WATCH CO., LTD.

2010/06/01 (12:48:28)

This drawing is provisional and subject to our reconfirmation and/or revision without notice.

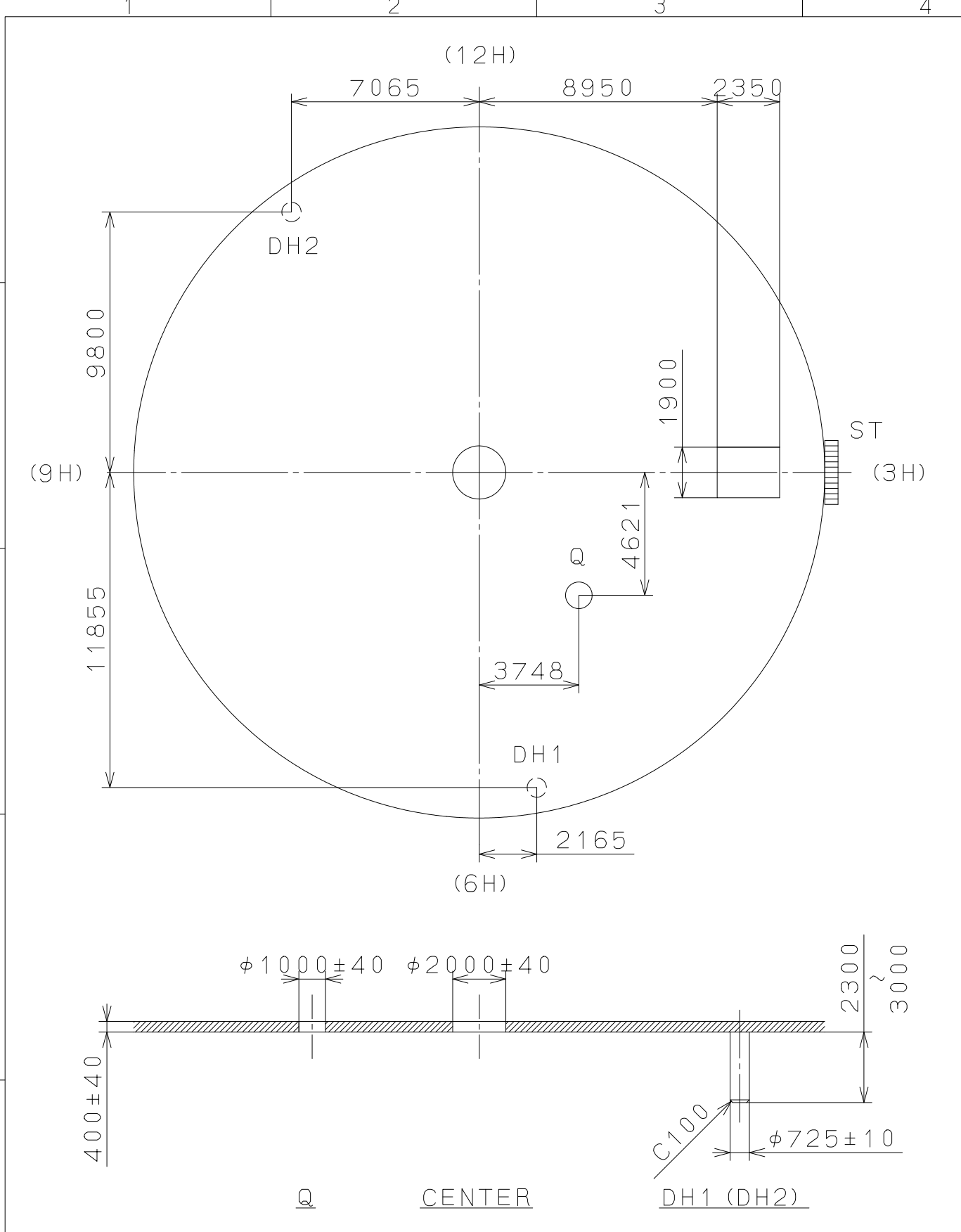

△			Quantity		Cal. NO.:
△			Unit	1/1000mm	8218-21A
△			Scale	5:1	Parts No.:
△			Date		
△			Drawn		
Mark	Date	Description	Appr.	Checked	Name:
		Alterations	Approved	N. Suzuki	Indications for Dial
Material					Drawing No.: 8218D000
Heat Treatment			General Tolerances	MIYOTA CITIZEN WATCH CO., LTD. TOKYO, JAPAN	
Hardness			Dimensions		
Plating			Angles		

2008/11/14 (11:30:42)

This drawing is provisional and subject to our reconfirmation and/or revision without notice.

A
B
C
D
E
F

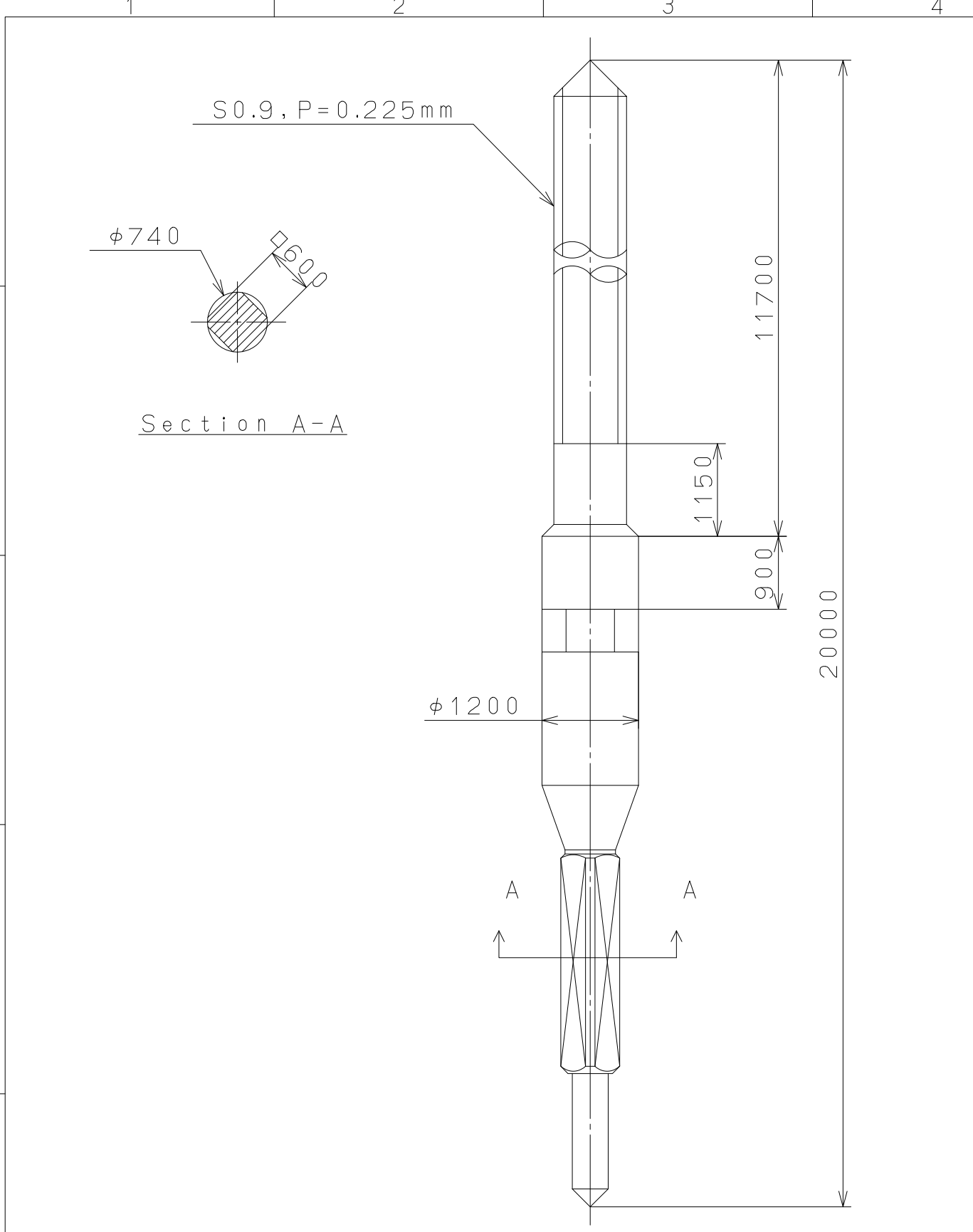

△5			Quantity		Cal.NO.:
△4			Unit	1/1000mm	
△3			Scale	15:1	Parts No.:
△2			Date		065-212
△1			Drawn		
Mark	Date	Description	Appr.	Checked	Name:
		Alterations	Approved	N. Suzuki	SETTING STEM
Material					Drawing No.: 2120S001
Heat Treatment			General Tolerances	MIYOTA CITIZEN WATCH CO., LTD. TOKYO, JAPAN	
Hardness			Dimensions		
Plating			Angles		

